

daxa  
TECHNOLOGIES

S2 PICO  
PROJECTOR



**User Guide**

# Caution!

WARNING: Please use this product as instructed. Misuse may cause injury or death.

DO NOT use while driving

DO NOT expose to water or wet surfaces. Electric shock may occur

DO NOT expose the projected LED image to your eyes or the eyes of others

DO NOT block or restrict airflow from ventilation holes as this may cause the projector to overheat

Keep the projector, battery, or charger away from any heat sources

## Caution for Battery Use

- Do not pierce or puncture the battery with sharp objects
- Do not heat the product or expose it to high temperature.
- Do not wet it or place it in any liquid

## Caution for Headphone Use

- Prolonged use at high volume may impair your hearing.
- High volume during walking or driving may cause distractions and result in injury or death

# Table of Contents

## Chapter 1: S2 at a Glance

S2 Introduction	1
Remote & Keypad	2
Accessories	3

## Chapter 2: Getting Started

Powering On / Off	4
Focus Adjustment / Throw	
Distance	5
Connecting to Speaker or Headphones	6
Loading External Content	7

## Chapter 3: Menu Screens

Main Menu	10
Brightness Menu	11
Video Player Menu	12
Photo Menu	16

Connecting to Device via Digital AV	20
Connecting to Device via USBC	23
Connecting to Composite Video	25
Ebook Viewer	27

## Chapter 4: Settings Menu

Picture Settings	29
Sound Settings	30
Option Settings	31

## Chapter 5: Technical Details

Troubleshooting	33
Specifications	34
Notes	35

# S2 at a Glance

# Chapter 1

## Main Unit Front/Back

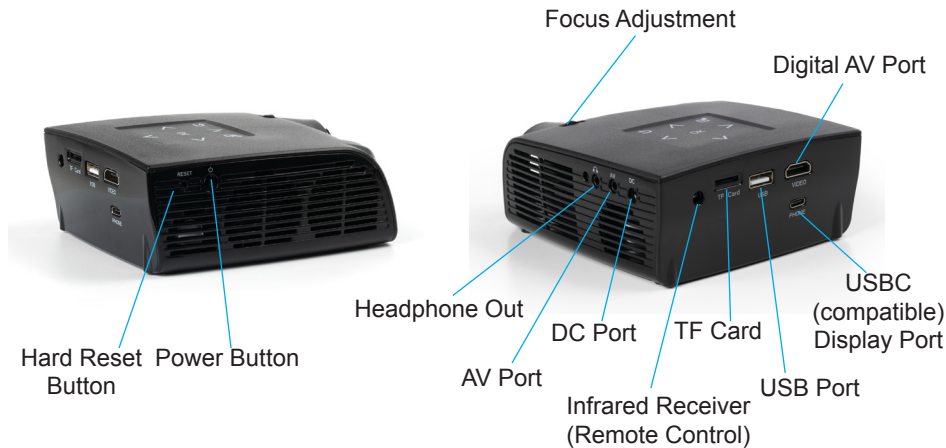

# Remote & Keypad

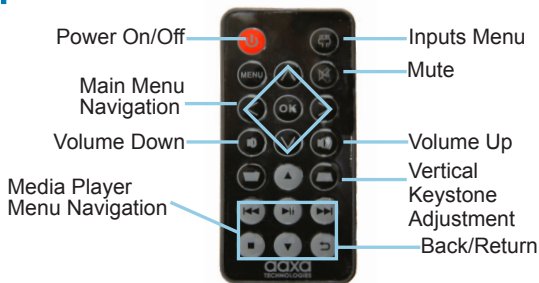

Remote

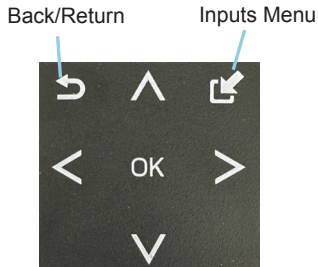

Both the keypad and remote can be used to navigate through the menus. The Main Menu Navigation on the remote functions exactly the same as the directional pad on the S2 unit.

*NOTE: Pressing power on the remote can only turn the projector off. The power button on the remote cannot turn the projector on.*

# Accessories



Remote

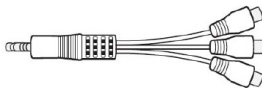

A/V Cable



Power Adapter



USBC to USBC  
Cable

*\*Under various circumstances, the actual accessories may be different from those shown in the pictures above.*

*Additional accessories are available for purchase at [www.aaxatech.com](http://www.aaxatech.com)*

## Powering ON the projector

1. To power-on a fully charged S2, hold down the power button for approximately five seconds until the projector turns on.

## Powering OFF the projector

1. Press the power button once, then again to confirm.
2. After a few seconds, the unit should turn off fully.

## Charging the projector

1. To charge your S2, use the power adapter supplied in the box. The LED indicator on the left side of the unit will light up red to show the projector is receiving power. Once the projector is fully charged, the LED indicator will turn green.
2. The S2 will take approximately 5 hours to fully charge from a full drain.

*NOTE: The S2's battery does not charge when it is in operation.*

# Focus Adjustment / Throw Distance

## Focus Adjustment

- Spin the focus wheel left or right until the image becomes clear.

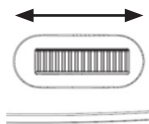

## Throw Distance Chart

Throw Distance Units: Inches	Diagonal Size Units: Inches
26	20
39	30
52	40
65	50
78	60
92	70
105	80
118	90

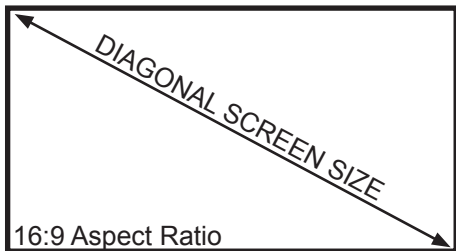

Throw Ratio 1.50

Projection Angle: 100% Offset

\*minimum throw distance: 13 inches



# Connecting Speakers / Headphones

**Step 1:** Connect your speakers/headphones to the projector's audio port.

**Step 2:** Ensure that the projector and/or the headphones are powered on.

**Step 3:** Place the headphones on and enjoy!



**\*CAUTION:** Prolonged use of headphones at a high volume may impair hearing.

# Loading External Content

The S2 can read files directly from both a TF Card and USB Drive.

Supported file types include:  
JPG / AVI / MP4 / GIF / BMP / TXT

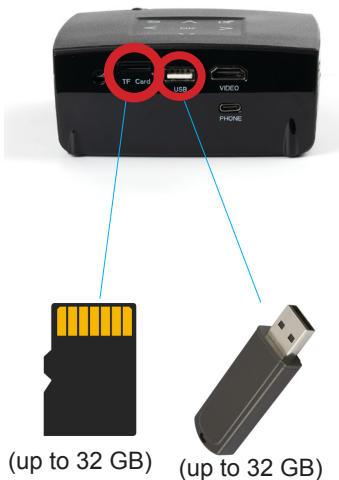

# Loading External Content Cont.

## How to insert your USB Drive

- Slide your USB Drive into the USB port.
- Gently slide the drive until it cannot go in any further.



(up to 32 GB)

## How to insert your TF Card

- Slide in your TF card into the TF card slot on the side of the S2 (as shown in picture).
- Gently slide the TF card until it clicks into place.



(up to 32 GB)

# Loading External Content Cont.

Once your TF Card or USB Drive is inserted into the projector, the TF Card or USB Drive should load automatically and the content can be found through the **Photos** and **Videos** icons located on the Main Menu, depending on the file type you wish to play. Loaded content can also be found through the **Text** icon, located within the Settings Menu.

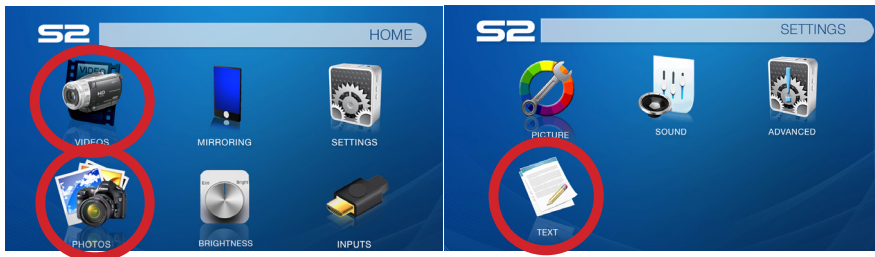

# Menu Screens

# Chapter 3

## Main Menu

The S2 features a built in PMP (Portable Media Player) function. This function allows the projector to play videos, pictures, and text files directly from your connected storage device.

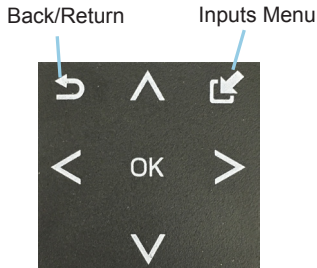

- Press the left and right directional buttons to choose an icon from the main menu.
- To select a menu option, press the “OK” button in the middle of the navigation pad.
- To go back to the previous screen, press the “Back” button.
- To return to the main menu, press the “Back” button twice.

# Brightness Menu

To change the brightness on your S2:

- Select the “Brightness” icon (Fig. 3.1)
- Select the brightness you wish (Fig. 3.2)
- Choose among Eco, Standard and Boost
- NOTE: Eco is the only available option when using off battery power.



Fig. 3.1



Fig. 3.2

# Video Player Menu

## Opening a file:

- Select the “Video” icon (Fig. 3.1).
- From the submenu (Fig. 3.2), select the storage media with the stored files.
- Choose which file you wish to play.

Fig. 3.1



Fig. 3.2



The S2 will show all folders and files you have on your USB or TF drive. Use the navigation buttons to select folders or files.

# Video Player Menu

## While Playing Videos

While playing videos, the volume is adjustable. Further controls are available in the video player submenu - which is accessed through the “OK” button.

\*Review Specification section of this manual for supported video formats.



Volume Down



Volume Up



Positive Keystone Adjustment



Negative Keystone Adjustment

\*Vertical adjustment only

## OK Enter Video Player Submenu

- To open/hide the video playback menu, use the “OK” and “Back” Buttons on the projector.



# Video Player Submenu

## Playing Videos

The Video Player Submenu can be accessed by pressing “OK” during video playback. To exit the Video Player Submenu, press the “Back” button or wait 5 seconds. To navigate the Playback Menu, use the directional buttons on the navigation pad or remote to highlight the option you wish to choose.

- To open/hide the video playback menu, use the “OK” and “Back” buttons on the projector.

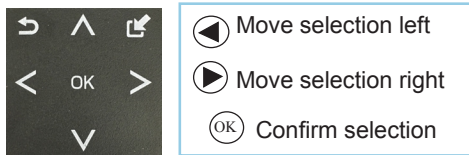
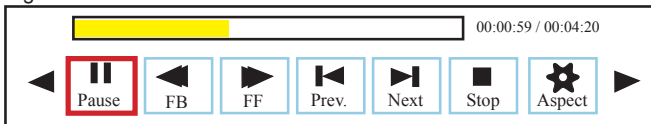

Fig. 3.3



# Video Playback FAQ

## How do I loop a video?

1. Choose either USB or TF Card for playback



2. Navigate the folders until you reach the file you wish to play.
3. Highlight the file you want to play, then confirm the selection.
4. Move selection on video player menu to “Repeat 1”, and confirm the selection.
5. The video will now loop after playback is finished.

# Photo Menu

## Opening A File:

- Select the “Photo” icon (Fig. 3.4).
- From the submenu (Fig. 3.5), select the storage media with the stored files.
- Choose which file you wish to play.

Fig. 3.4



Fig. 3.5



The S2 will show all folders and files you have on your USB or TF Card drive. Use the navigation buttons to select folders or files.

# Photo Menu

## While Viewing Pictures

While viewing pictures, further controls are available in the Photo Submenu - which is accessed through the “OK” button.



Previous Picture



Next Picture



Positive Keystone Adjustment



Negative Keystone Adjustment

\*Vertical adjustment only



## Enter Photo Player Submenu

- To open/hide the Photo Playback menu, use the “OK” and “Back” Buttons on the projector.

# Photo Submenu

## Viewing Pictures:

The Photo Submenu can be accessed by pressing “OK” during picture slide-show playback. To exit the Photo Submenu, press the “Back” button or wait 5 seconds. To navigate the playback menu, use the directional buttons on the navigation pad or remote to highlight the option you wish to choose (Fig 3.6).

\*Review Specification section of this manual for supported picture formats.

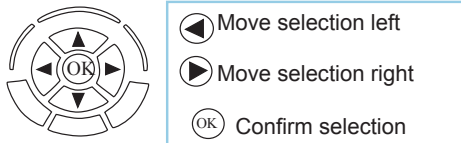
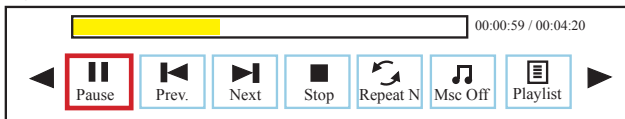

Fig 3.6



# Photo Slideshow FAQ

## How do I play a slideshow?

1. Choose either USB or TF Card for playback



2. Navigate to the folder that contains the pictures you wish to view in the slideshow.
3. Confirm selection of the first picture.
4. Press “play” in the photo menu
5. Slideshow will now play.
6. NOTE: Selecting “Repeat A” will loop slideshow.

## How do I manually control the slideshow?

1. After selecting the photo you wish to be displayed, you can press “play” to start the slideshow (as outlined in the previous FAQ).
2. To manually control the slideshow, you must stop the slideshow with the “stop” button.
3. You may use either the controls on your remote or on top of the projector itself to flip through the pictures in the current playlist.
4. You can change the SlideShow duration in the Settings Menu (Main Menu -> Settings -> Picture)

# Connecting to a Device via Digital AV

The S2 has a Digital AV port for a wide range of compatibility. A digital AV cable is required to connect your S2 to your other device.

In the Main Menu



Select "INPUT" icon



Select "Digital AV" icon

## Connectivity to Multimedia Devices

The S2 can connect to many media devices including: computers, laptops, iPhones, iPads, DVD players, smart phones, cameras, video game consoles and other peripherals with ease.

*\*Some smartphones and tablets require video out capabilities to be displayed with the S2. Check with the manufacturer.*

# Connecting to Digital Video Input

## Step 1:

Connect one end of the Digital AV Cable to your device's Digital AV port.



## Step 2:

Connect the other end of the Digital AV Cable to your S2's Digital AV port.



## Step 3:

In the Main Menu, select the "Digital AV" Icon. Your S2 should now be mirroring the content from your device.

## Note:

If you're connecting to a computer or laptop and the projector does not automatically mirror it, read onto the next page for more information.



# Connecting to a Computer Cont.

## Step 4:

Enabling Digital Video output on your Computer – To enable Digital Video output on your computer most computers require “turning on” the video output feature. Each computer is different. Please consult your owner’s manual for instructions to enable Digital Video output. Below are standard instructions for a Windows 10 computer – not all systems are the same.

## Step 5:



Press Windows+P to toggle through display settings. Select either “Duplicate” or “Extend” depending on your viewing option

*\*NOTE: different operating systems may differ*

## Step 6:

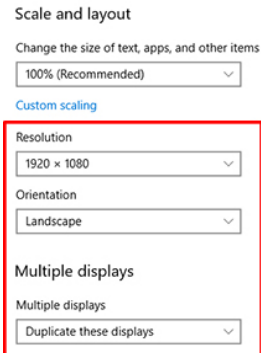

1. Right click on computer desktop and select “Screen Resolution”
2. Display Properties window will pop up
3. If a secondary monitor is grayed out, click on it and select “Extend these displays” in the “Multiple Displays” drop down
4. If the image is blurry or the text is not legible, adjust the screen resolution. We recommend 1920x1080

# Connecting to a Device via USB-C (Compatible) Display Port

The S2 has a Usbc (compatible) Display Port for easy mirroring of devices with a USB-C Video Output. The included USB-C Cable is required to connect your S2 to your other device.

In the Main Menu



Select "INPUT" icon



Select "Mirror" icon

## Connectivity to Multimedia Devices

The S2 can connect to many media devices including: computers, laptops, iPads, and smart phones

*\*Device requires video out capabilities through USB-C to be displayed with the S2. Check with the manufacturer.*

# Connecting to a Device via USBC (Compatible) Display Port Cont.

## Step 1:

Connect one end of the USBC Cable to your device's USBC (compatible) Display Port.

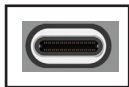

## Step 2:

Connect the other end of the USBC Cable to your S2's USBC (compatible) Display Port.



## Step 3:

In the Main Menu, select the "Mirror" Icon. Your S2 should now be mirroring the content from your device.

**NOTE:** *When connecting to a USBC device, the S2 may experience shorter battery runtime due to the continuous charge the S2 is providing to the connected USBC device.*

# Connecting to Composite Video

## Step 1:

Connect the 3.5mm Composite AV Cable to the back of the S2.



## Step 2:

Connect the composite end of the AV Cable (Red, White, Yellow) to your device.



# Connecting to Composite Video Cont.

## Step 3:

In the Main Menu



Select "INPUT" icon



Select "RCA"

## Step 4:

Turn on your multimedia device.

### Connectivity with multimedia devices

The S2 can connect to many media devices including: VHS players, DVD players, Blu-Ray players, cameras, video game consoles and other peripherals with ease.

# E-Book Viewer Menu

## Opening A File:

- The E-Book Viewer is located in the Setting's Menu
- Select the “Settings” Icon
- Select the “Text Viewer” icon (Fig. 3.10)
- Choose the file you wish to play.

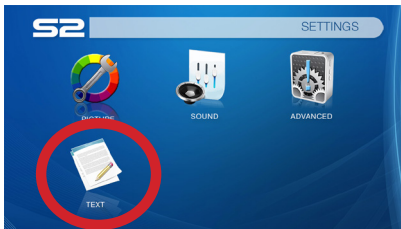

Fig. 3.10

The S2 will show all folders and files you have on your USB or TF Drives. Use the navigation buttons to select folders or files.

## Viewing Text Files:

The S2 Micro Projector allows you to view text files. Select the file you want to view in the file menu for the particular storage device on which the file is stored. You can press the left and right arrow buttons on the directional pad or remote to flip through the pages you have in the present folder.

*Note: Microsoft Office and PDF file formats are not supported. To view a slideshow convert your slideshow into JPEG pictures first.*

# Settings Menu

# Chapter 4

The Settings Menu can be accessed by selecting "Settings" on the Main Menu



Within the settings menu, there are three more submenus that allow you to customize your S2 to the settings you want.

## Picture

- Picture Mode
- Color Temperature
- Aspect Ratio
- Noise Reduction
- Brightness Mode
- Projection Direction
- Slideshow Time

## Sound

- Sound Mode
- Balance
- Auto Volume

## Advanced

- OSD Language
- Restore Factory Default
- Software Version

# Picture Settings

## Picture Mode

- Changes the picture mode to different settings depending on your usage

## Color Temperature

- Adjusts the color temperature from warm to cool (red to blue)

## Aspect Ratio

- Changes the aspect ratio of the picture - Auto, 4:3, 16:9\*, etc.

## Projection Direction

- Flips the projected image

## Slideshow Time

- Changes the time each slide displays when playing a slideshow



\*Caution: Some pictures may be cut off when aspect ratio is set incorrectly

\*\*Boost mode should only be used in low temperature environments with adequate clearance of exhaust / intake vents. A tripod is highly recommended. **DO NOT block vents while operating in Boost mode.**



# Sound Settings

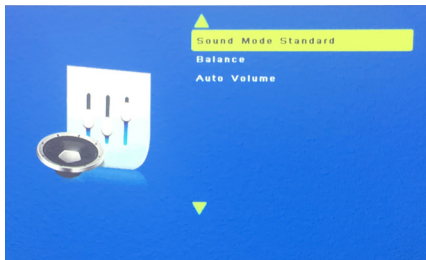

## Sound Mode

- Changes the sound mode depending on what is currently playing

## Balance

- Adjusts the sound balance manually

## Auto Volume

- With the Auto Volume On, the video can be opened with volume automatically

# Option Settings

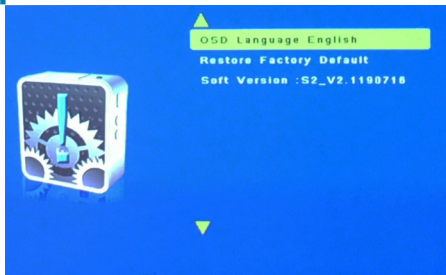

## OSD Language

- Changes the language of the device. Options include English, Spanish, Chinese, German, French

## Restore Factory Default

- Restores the projector to factory settings

## Software Version

- Current software version in use

## Troubleshooting

### IMAGE IS BLURRED

Possible Causes	Solution
The Projector is not in focus	Adjust the focus with the focus adjustment dial until the image comes into focus
The Projector is offset from plane / angle of operation	Move the projector so that it is both 180 degrees and on an even plane with the screen or adjust the keystone through the remote or keypad.

### NO SYNC, NO SIGNAL

1. Be sure to setup the computer to enable a video signal output. On some laptops this is done by pressing and holding Function F5 key. If using the S2 as an external monitor on Windows based systems, this can be done by selecting "extend my desktop to this monitor". The native resolution of the S2 projector is 1280x720. Depending on the video driver different resolutions may need to be selected for proper output.

# Technical Details

## Troubleshooting

### THE PROJECTOR DOES NOT TURN ON

Possible Causes	Solution
There is no power	Check to ensure the power outlet source is good. Check the power adapter to ensure a proper connection with the wall outlet as well as the projector. Confirm that the unit is charged and has enough power
The power button was not held long enough	To power on the projector, the power button needs to be depressed for a full 5 seconds. Try holding the power button until the optical engine turns on

### NO PICTURE / FILE NOT SUPPORTED

Possible Causes	Solution
The video source is not properly connected or selected	Check the video source signal to ensure that it is properly connected. Select the current input source by choosing the input desired from the main menu
Incorrect file extension / Video is encoded with incorrect codec	Please refer to “Specifications” page to see which file types and codex are supported. Verify that the file was encoded properly.

# Specifications

<b>Brightness:</b>	<b>400 Lumens</b>
<b>Native Resolution:</b>	<b>1280x720 (720P)</b>
<b>Contrast Ratio:</b>	<b>1000:1</b>
<b>Aspect Ratio:</b>	<b>16:9</b>
<b>Battery Runtime</b>	<b>360 Minutes (Eco Mode)</b>
<b>Keystone:</b>	<b>Vertical</b>
<b>Projection Lens:</b>	<b>Manual Focus</b>
<b>Image Size:</b>	<b>10~120 inches</b>
<b>Lamp:</b>	<b>Triple RGB LEDs with Vibrant Color Technology Life 30,000hrs</b>
<b>Video in:</b>	<b>Composite A/V Digital AV (Compatible with Full Size HDMI™) USB (Compatible) Display Port</b>
<b>Audio Output:</b>	<b>2.0 W Speaker; 1 W Tweeter 3.5 mm audio jack</b>
<b>TF Card:</b>	<b>TF Card Slot (32GB maximum)</b>
<b>USB:</b>	<b>5 Pin USB 2.0 (Full Size) (32GB maximum)</b>
<b>Dimensions:</b>	<b>5.2" x 4.5" x 1.9"</b>
<b>Weight:</b>	<b>1.28 lbs</b>
<b>Supported File Formats:</b>	<b>JPG, AVI, BMP, GIF, TXT</b>



# Notes

---

---

---

---

---

---

---

---

---

---

---

Please direct all customer service inquiries to:

AAXA Technologies, Inc.  
17781 Sky Park Cir., Suite #F  
Irvine, CA 92614  
(714) 957-1999  
[info@aaxatech.com](mailto:info@aaxatech.com)